

# THE INSTRUCTOR INTERFACE WITH COLLABORATE

## ENTERING A SESSION

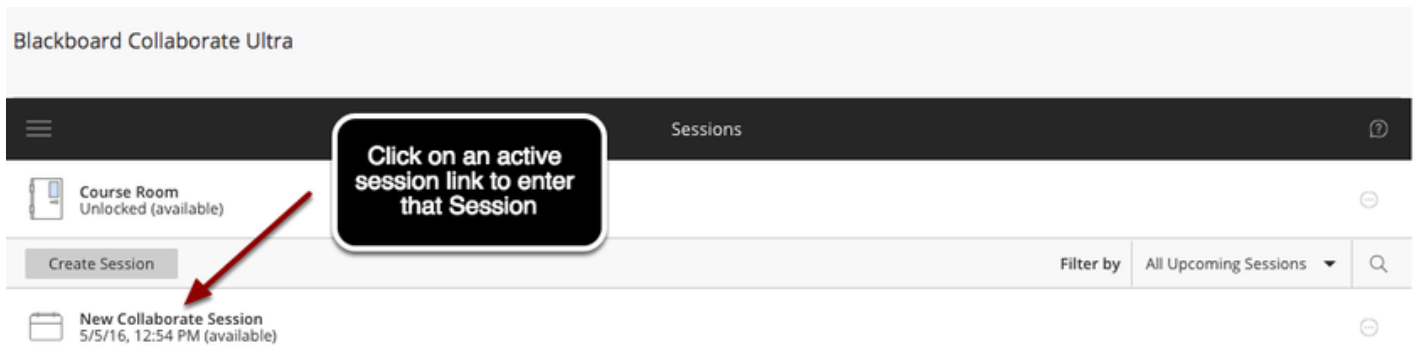

To enter a Collaborate Ultra Session, simply click on the name (link) for an active session. If you created the session, if you are the instructor who created the session, then you will automatically enter the session as a Moderator.

## THE MODERATOR INTERFACE MAIN SCREEN

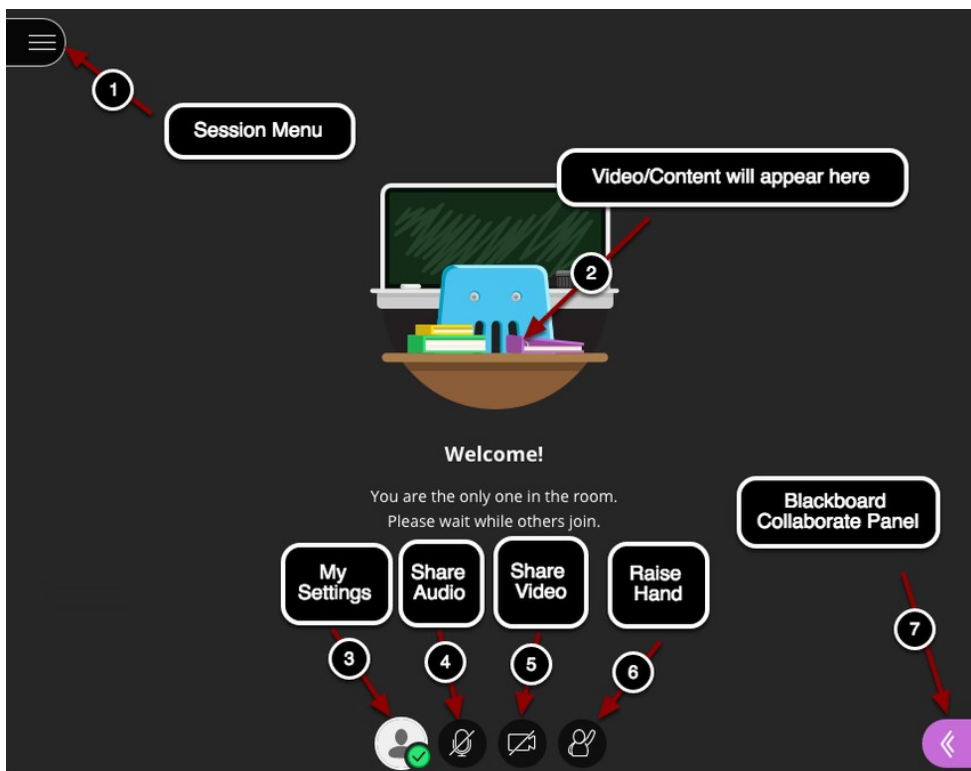

Starting with the icons at the top of the page, from left to right:

1. **Open Session Menu:** Click on this button to start recording, switch between telephony and computer audio, report an issue to Blackboard, access Blackboard Collaborate Help and tutorials, and to leave the session.
2. **Content Display:** Video, whiteboards, and shared files will appear here.
3. **My Settings:** Clicking this icon will bring up the My Setting pop-over window which allows you to add a photo, set up and change your audio and video settings, generate a phone number for telephone audio, change your notification

settings, and change your session settings. Clicking on the check icon will allow you to change your status or send feedback to the room.

4. **Share Audio:** Clicking this icon will toggle your microphone off and on.
5. **Share Video:** Clicking this icon will toggle your video off and on.
6. **Raise Hand:** Clicking this icon will alternately "raise" or "lower" your hand, a raised hand. Just as in a face-to-face classroom, you can use this to indicate that you have a question or want to answer a question.
7. **Collaborate Panel:** Clicking this icon opens the Collaborate Panel, where you can access the Chat, Participant List, Share Content, and My Settings menus.

## THE SESSION MENU

Here is a description of the options available in the **Session Menu**. These options will be covered in more detail in individual guides.

1. **Close:** Click the X button to close the menu and return to the session.
2. **Start Recording:** Click this option to start session recording.
3. **Use your phone for audio:** Click this option to switch audio modes.
4. **Report an Issue:** Click this option to submit a report to Blackboard if you encounter problems during the session.
5. **Tell me about Collaborate:** Click this option to view a short tutorial on the Blackboard Collaborate interface.
6. **Blackboard Collaborate Help:** Click this link to access Blackboard's help resources.
7. **Privacy Policy:** Click this link to view Blackboard's privacy policy.
8. **Leave Session:** Click this option to exit the session. You can reenter the session as long as the session is live.

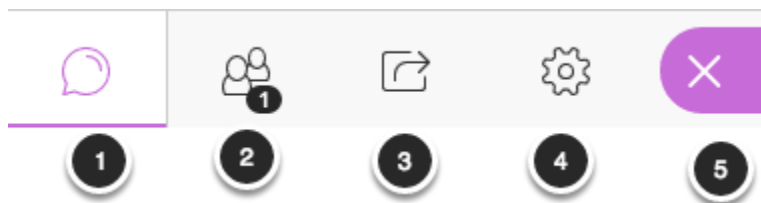
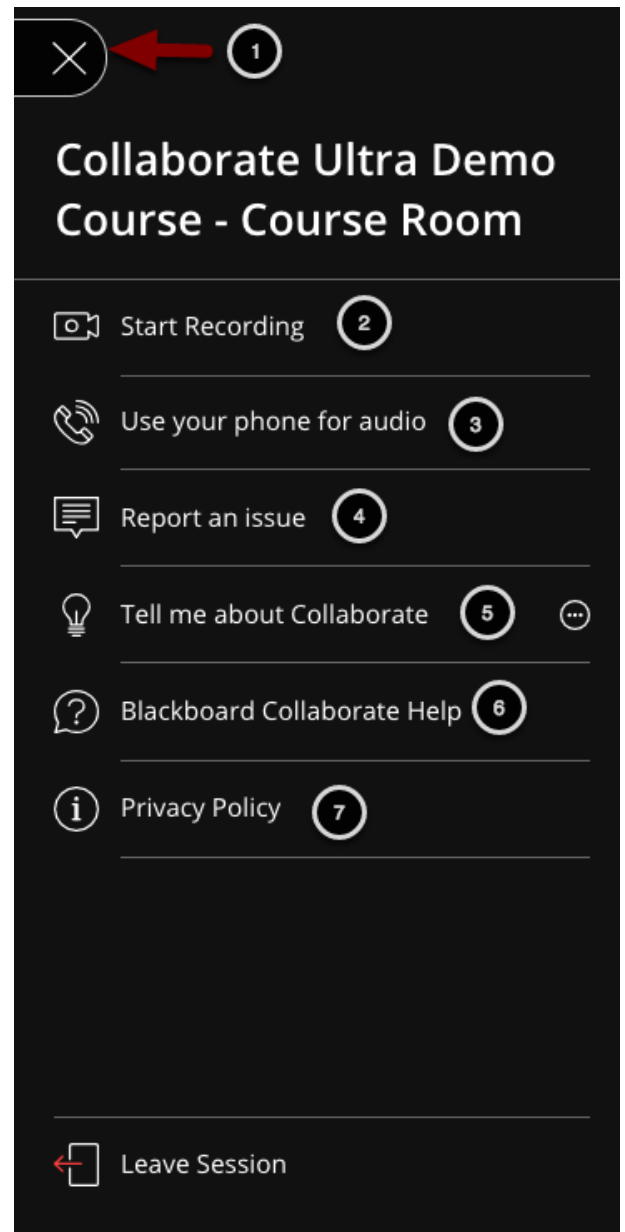

## THE COLLABORATE PANEL

This panel allows you to manage the session interactivity as you need to interact with your course content and participants:

1. **Chat:** Click the Chat button to open the Chat window.
2. **Participants List:** Click this button to view the Participants List.
3. **Share Content:** Click this button to share content with participants.
4. **My Settings:** Click this button to change your session settings.
5. **Close:** Click the X button to close the Collaborate Panel.